

## Arsys IP44 Sealing Set

Order no.: 1010 00

### Installation instructions

#### 1 Safety instructions

The protection category IP44 is only guaranteed if assembly is performed in accordance with these instructions.

Electrical equipment must only be installed and assembled by qualified electricians.

Disconnect before working on the device. Take into account all circuit breakers that supply dangerous voltages to the device or load.

Failure to comply with these instructions may result in damage to the device, fire or other hazards.

#### 2 Function

##### Intended use

The protection category IP44 can be achieved during installation with the supplied sealing set

- in flush-mounted boxes according to DIN 49073, Part 1
- on smooth, even, vertical walls
- in flush-mounted boxes.

 The protection category IP44 is not ensured in the case of floor mounting, ceiling mounting and mounting in hollow-wall boxes.

#### 3 Information for electricians

##### 3.1 Installation



##### **DANGER!**

**Touching live parts can result in an electric shock.**

**An electric shock can lead to death.**

**Before working on the device or load, disconnect all associated circuit breakers.**

**Cover all live parts in the area.**

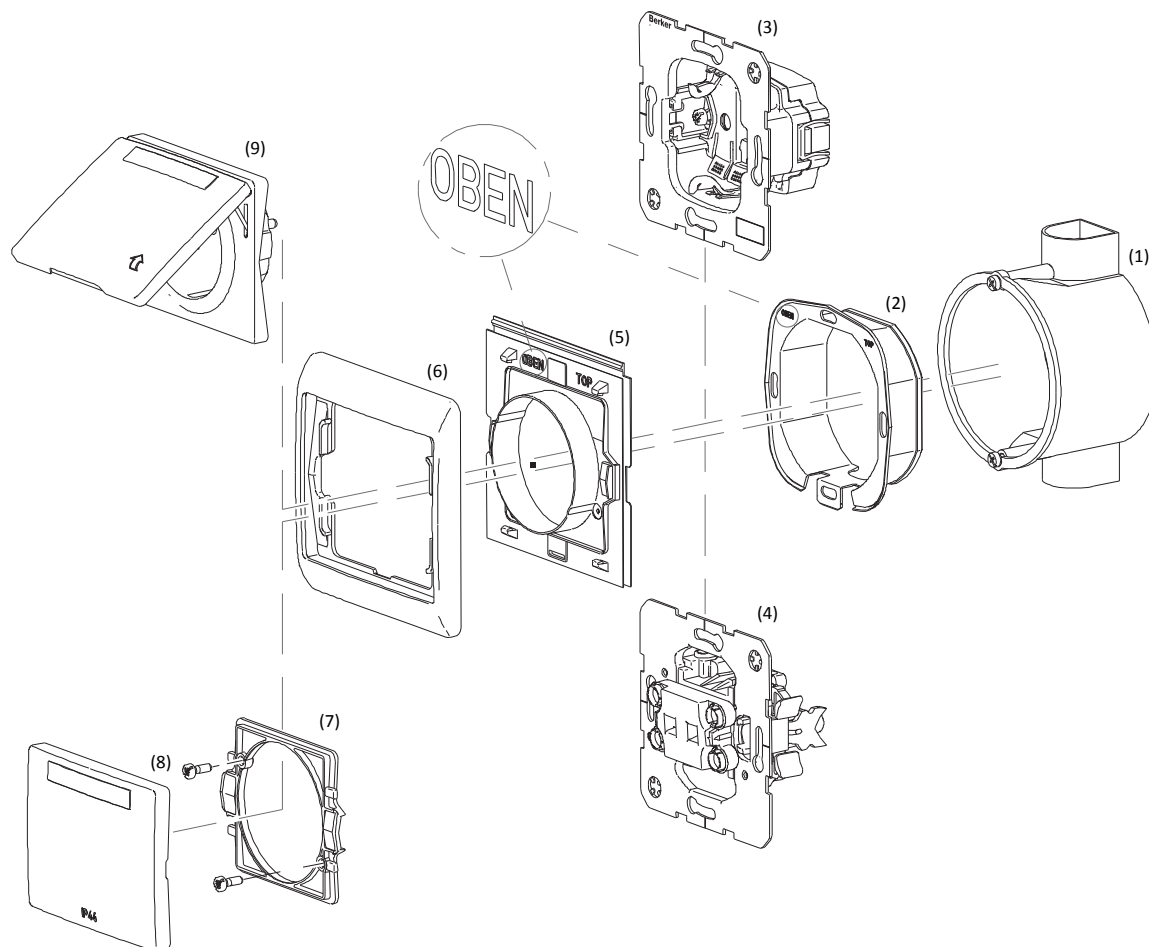

Figure 1

### Install device with sealing set (Figure 1)

- Insert sealing flange (2) into the flush-mounted box (1). Note the proper direction (marking **TOP/OBEN**).
- Connect the socket outlet insert (3) or the switch insert (4) and install into the flush-mounted box.

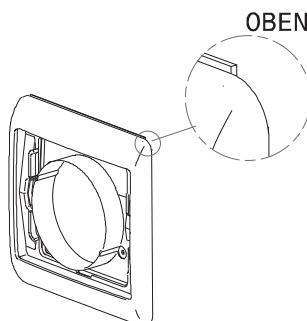

Figure 2

- Insert seal (5) into the frame from the rear (Figure 2) as illustrated. Note the proper direction (marking **TOP/OBEN**).

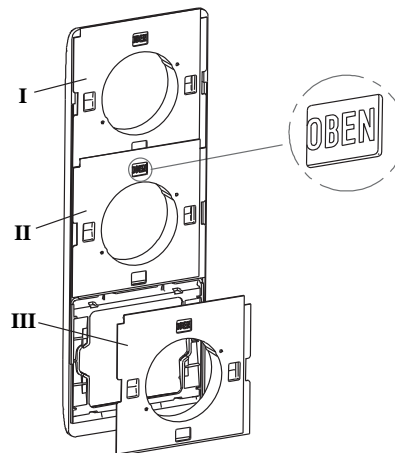

Figure 3

- i** Note installation sequence for vertical combinations: Insert seals starting from the top into the frame (Figure 3).
- Fit frame (6) with seal.
  - Install design cover.  
 With switch inserts (4):  
 Screw frame together using fastening piece (7) and snap on rocker (8).  
 With socket outlets:  
 Screw frame together using screws from the central element of the socket outlet (9).

**Berker GmbH & Co. KG**  
 Klagebach 38  
 58579 Schalksmühle/Germany  
 Phone: + 49 (0) 23 55/905-0  
 Fax: + 49 (0) 23 55/90 5-111  
[www.berker.com](http://www.berker.com)